

ATTEN-SMSF-15



Inline Attenuator, SMA-m/SMA-f, 15 dB

Product Classification

Product Type Coax attenuator

General Specifications

Connector Interface SMA Female | SMA Male

Outer Contact Plating Gold

Plating Gold

Dimensions

Length 30 mm | 1.181 in

Diameter 10 mm | 0.394 in

ATTEN-SMSF-15

Outline Drawing

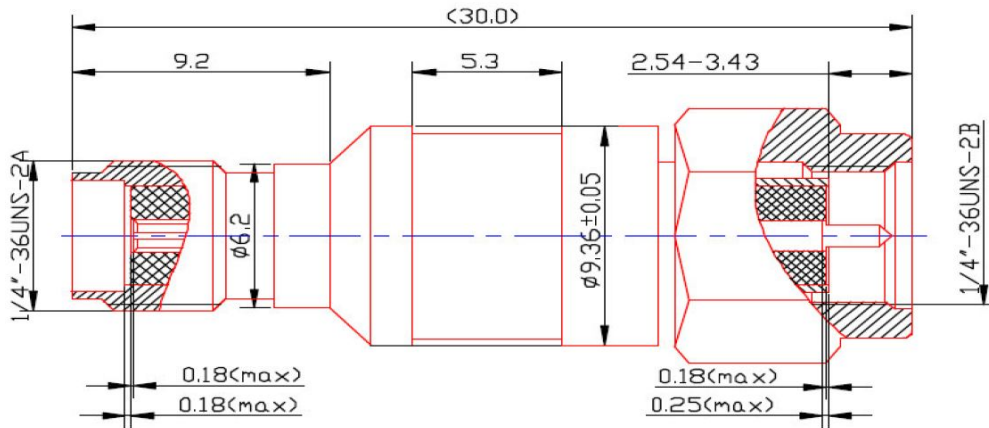

Electrical Specifications

Input Power, PEP, maximum	100 W
Input Power, RMS, maximum	2 W
Return Loss, minimum	20 dB
Attenuation	15 dB
Attenuation Tolerance	± 0.5 dB
Impedance	50 ohm
Operating Frequency Band	DC – 3000 MHz

Material Specifications

Dielectric Material	PTFE
Material Type	Brass
Inner Contact Plating	Gold

Environmental Specifications

Operating Temperature	-30 °C to +80 °C (-22 °F to +176 °F)
------------------------------	--------------------------------------

Packaging and Weights

Weight, net	8 g 0.018 lb
--------------------	----------------

Regulatory Compliance/Certifications

Agency	Classification
---------------	-----------------------

ATTEN-SMSF-15

CHINA-ROHS	Below maximum concentration value
REACH-SVHC	Compliant as per SVHC revision on www.commscope.com/ProductCompliance
ROHS	Compliant
UK-ROHS	Compliant

